

Table top Commercial Gas CharBoiler

PARAMETERS SHEET

MODEL#: TFCB SERIES



MODEL # TFCB-24-RH

Specifications

- Stainless steel body
- Cast iron gas burner
- CSA approved Gas Valve
- Manual ignition
- With Pilot Switch

Choose GAS TYPE When Placing Order

- LPG**
Liquefied Propane Gas
- Town Gas**

Models in TFCBseries

- TFCB-24-RH**
- TFCB-36-RH**
- TFCB-48-RH**

Standard Accessories

- Adjustable bullet leg
- Convert kit of LP gas and NG

PRODUCT DIMENSION CHART

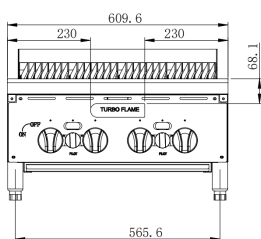

TFCB-24-RH

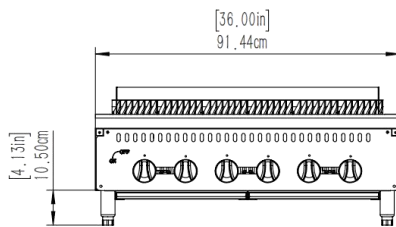

TFCB-36-RH

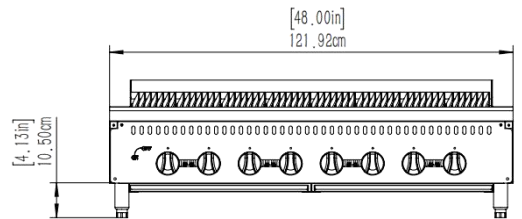

TFCB-48-RH

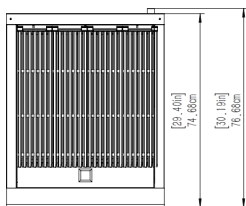

Top View

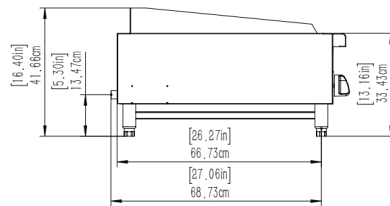

Side View

Key Parameters

Model	Product Dimension	Heat Power	Heating Burner	Gas Consumption	Gas inlet Connection	N.W	G.W	Packing dimension
TFCB-24-RH	24x29.05x16.38 inch 609.6x737.8x416mm	80,000 BTU/H	4	LPG: 0.906m ³ /h Town Gas: 2.104m ³ /h	3/4" NPT Male	89.5kg	105.5kg	740X890X500mm
TFCB-36-RH	36x29.05x16.38 inch 915x737.8x416mm	120,000 BTU/H	6	LPG: 1.36m ³ /h Town Gas: 3.156m ³ /h	3/4" NPT Male	124.5kg	150kg	1050x890x500mm
TFCB-48-RH	48x29.05x16.38 inch 1210x737.8x416mm	160,000 BTU/H	8	LPG: 1.813m ³ /h Town Gas: 4.209m ³ /h	3/4" NPT Male	159kg	194kg	1340x890x500mm